

# Drawer

## Installation Guide

NOTE: This instruction sheet is for informational purposes only. Your working environment may differ from what is shown in the pictures. Please determine location of wiring and plumbing before you begin.

It is your responsibility to ensure proper installation and, if in doubt, contact customer service.

While our products are designed for homeowner installation, you assume all risk associated with the installation process. If you so choose you may refer to our video (<https://youtu.be/vSwfX4OFvYo>) for these instructions.

Inside your drawer packaging you will find everything you need to assemble and install your drawers:



Identify and separate the bottom drawer face, which will be different in height from the others:

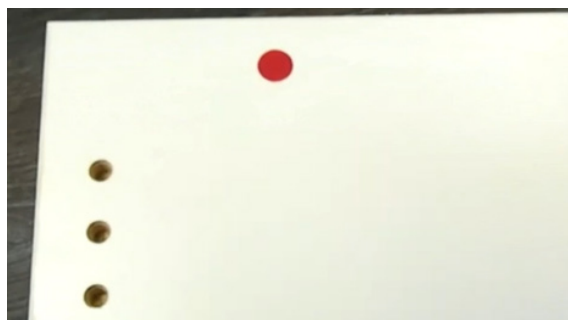

The other included components are the drawer slides...



# Drawer

## Installation Guide

The undermount drawer clips...



...Which include controls for horizontal and vertical drawer adjustments:

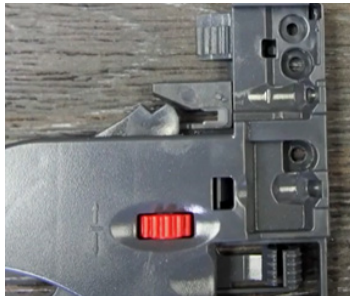

The drawer clips, used for securing the drawer sides to the drawer face:



Decorative covers for hiding the adjustment and connection hardware inside the side panels:



# Drawer

## Installation Guide

Euro screws for fastening the glides into the pre-drilled holes in the closet panels:



5/8" screws, used for the drawer assembly:

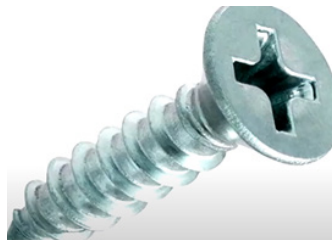

1/2" screws, used for attaching the undermount clips to the bottom of the drawer:



Before you install your drawers, be sure that you used flat metal corner braces instead of plastic brackets to fasten your closet panels to the wall in areas that will be behind drawers to prevent any clearance issues:



# Drawer

## Installation Guide

Once your closet panels are ready to receive the drawers, you can assemble them as follows:

Lay the components out and slide the bottom panel into the sides:



Then place the back panel into place against the rear mounting brackets:

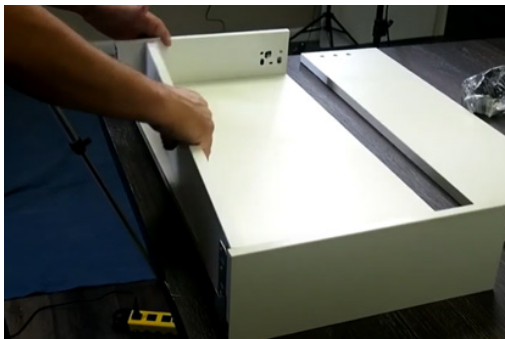

Once everything is lined up squarely, use your 5/8" screws to fasten the back panel to the rear mounting brackets:



Turn the drawer box over and install 5/8" screws into each corner to secure the bottom panel to the sides:

# Drawer

## Installation Guide



Next install the undermount drawer clips to the bottom using the bundled ½" screws. They should be aligned with the front edge of the bottom panel and right against the side panel:



There is a left and right undermount clip for each drawer. Make sure you install them as shown, with the levers pointing toward the center of the drawer:



Now install the drawer clips into the pre-drilled holes in the front panel. Please note the orientation of the protruding portion of the clip – it should be towards the vertical center of the face:



# Drawer

## Installation Guide

Push the clips into place and tap them in if necessary:



Then tighten the screw heads to firmly anchor the clip to the drawer base:



Next, snap the drawer face onto the drawer box. Please note the orientation of the clip as it is inserted:



Push the drawer face firmly into place until it clicks:





# Drawer

## Installation Guide

If you ever need to detach the drawer face from the drawer, you can do so by inserting and turning a screwdriver into this opening in the side panel mechanism:



Next you will install your drawer slides, which will be fastened to the pre-drilled holes in the side panels using the included euro screws:



There will be left and right drawer slide hardware for each drawer. They should be installed with the hook at the rear of the drawer and mounted just inside the front edge:

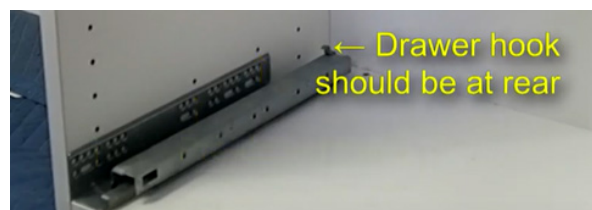

Place the drawer on the rails and then slide the rails forward so they click into the undermount clips:



# Drawer

## Installation Guide

Your drawer is now installed. Repeat this process as necessary for the remaining drawers.



You can then adjust the alignment of the drawers using the controls on the undermount clips to move the drawer box up and down or left and right:

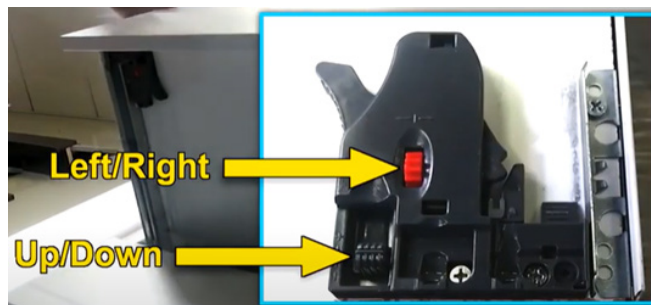

If necessary, further fine-tuning of alignment can be done using the drawer face adjustment screws located in the side panel mechanism:



Once you are done, snap the covers over the hardware mechanism openings on each side panel and your drawer installation is complete!

You may also refer to our videos by visiting the following website - <https://closetvids.com/>